

DiamondShield™

A balanced, open-grid glass fiber mesh

COLORS

White

PACKAGING

96.5cm x 45.7m (38" x 150')

4 rolls per box

USES

For use with: Master Builders Solutions Stucco Wall Systems, Master Builders Solutions Stucco Resurfacing Systems and conventional two or three coat stucco systems.

DESCRIPTION

DiamondShield is a balanced, open-grid triaxial glass fiber mesh that distributes stress across three directions. The unique design is engineered specifically for use with Master Builders Solutions Base Coats as an overlay system applied to new or existing stucco (Portland cement plaster). Improvements in tensile and flexural strength provided by DiamondShield result in superior crack resistance properties on new or retrofit stucco applications.

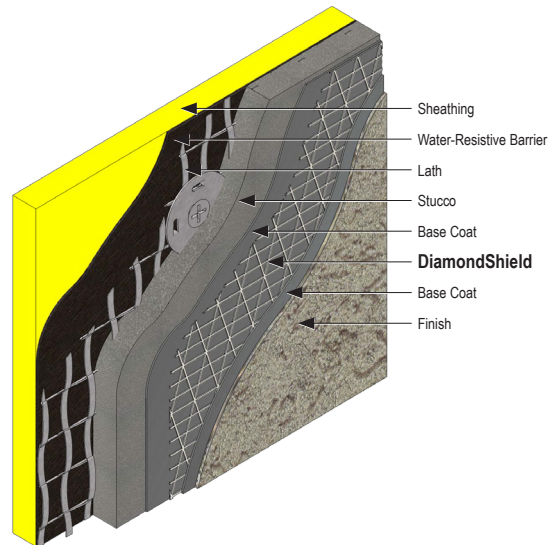

ADVANTAGES

Alkali resistant, compatible with all Master Builders Solutions Base Coats; high tensile strength and flexibility for long-term durability.

Increased flexural & tensile strength at ultimate load compared to stucco without DiamondShield/Master Builders Solutions Base Coat.

Fiberglass mesh / base coat overlay systems applied to stucco are recommended by various Lath and Plaster Bureaus

Made in the USA in a ISO 9001:2008 certified manufacturing facility

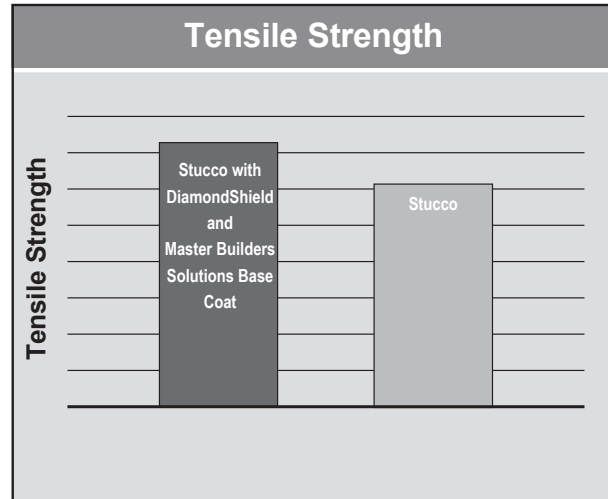
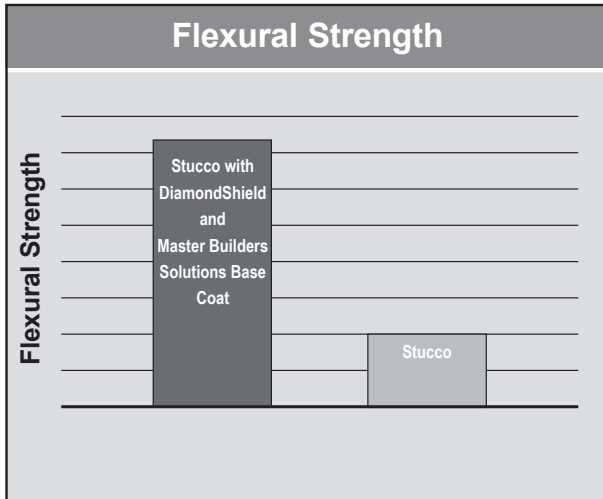

TECHNICAL SUPPORT

Consult Master Builders Solutions Technical Services Department at +1 (800) 589-1336 for specific recommendations concerning all other applications. Consult the Wall Systems website at www.master-builders-solutions.com/en-us, for additional information about products and systems and for updated literature.

APPLICATION

Note: Allow stucco to cure a minimum of 6 days prior to application of Master Builders Solutions Base Coat / DiamondShield.

1. All surfaces to receive Master Builders Solutions Base Coat and DiamondShield must be clean, dry and free of contaminants.
2. Apply mixed Master Builders Solutions Base Coat to entire surface of stucco with a stainless steel trowel.
3. Immediately place DiamondShield against wet Master Builders Solutions Base Coat and embed DiamondShield into the Master Builders Solutions Base Coat by troweling from center to the edges.
4. Lap DiamondShield 64mm (2 1/2") minimum at edges.
5. Ensure DiamondShield is continuous, void of wrinkles and embedded in Master Builders Solutions Base Coat so that no DiamondShield is visible.
6. If required, apply a second layer of Master Builders Solutions Base Coat to achieve total

nominal Master Builders Solutions Base Coat / DiamondShield thickness of 1.6mm (1/16").

7. Allow Master Builders Solutions Base Coat with embedded DiamondShield to dry hard (normally 8 to 10 hours) prior to finish coat application.

LIMITATIONS

1. Protect DiamondShield during transportation and installation to avoid physical damage.
2. Store DiamondShield in a cool, dry place protected from exposure to moisture.
3. See specifications and details for complete information on installation of Master Builders Solutions Wall Systems.
4. Apply in temperatures of 4 °C (40 °F) and higher.
5. Not for use in Exterior Insulation and Finish Systems (EIFS).

LIMITED WARRANTY NOTICE

Master Builders Solutions Construction Systems US, LLC ("Master Builders") warrants this product to be free from manufacturing defects and to meet the technical properties on the current Technical Data Guide, if used as directed within shelf life. Satisfactory results depend not only on quality products but also upon many factors beyond our control. MASTER BUILDERS MAKES NO OTHER WARRANTY OR GUARANTEE, EXPRESS OR IMPLIED, INCLUDING WARRANTIES OF MERCHANTABILITY OR FITNESS FOR

A PARTICULAR PURPOSE WITH RESPECT TO ITS PRODUCTS. The sole and exclusive remedy of Purchaser for any claim concerning this product, including but not limited to, claims alleging breach of warranty, negligence, strict liability or otherwise, is shipment to purchaser of product equal to the amount of product that fails to meet this warranty or refund of the original purchase price of product that fails to meet this warranty, at the sole option of Master Builders. Any claims concerning this product must be received in writing within one (1) year from the date of shipment and any claims not presented within that period are waived by Purchaser. MASTER BUILDERS WILL NOT BE RESPONSIBLE FOR ANY SPECIAL, INCIDENTAL, CONSEQUENTIAL (INCLUDING LOST PROFITS) OR PUNITIVE DAMAGES OF ANY KIND.

Purchaser must determine the suitability of the products for the intended use and assumes all risks and liabilities in connection therewith. This information and all further technical advice are based on Master Builders' present knowledge and experience. However, Master Builders assumes no liability for providing such information and advice including the extent to which such information and advice may relate to existing third party intellectual property rights, especially patent rights, nor shall any legal relationship be created by or arise from

the provision of such information and advice. Master Builders reserves the right to make any changes according to technological progress or further developments. The Purchaser of the Product(s) must test the product(s) for suitability for the intended application and purpose before proceeding with a full application of the product(s). Performance of the product described herein should be verified by testing and carried out by qualified experts.

FOR PROFESSIONAL USE ONLY. NOT FOR SALE TO OR USE BY THE GENERAL PUBLIC.

For the most current version of this literature, please visit our website at www.master-builders-solutions.com/en-us.