

## Secondary Moisture Protection Barrier Guidelines for Acrowall-CP System

A secondary moisture protection barrier must be installed over sheathed substrates and wrapped into rough openings prior to installation of ACROWALL-CP. Suitable secondary moisture protection barriers include minimum grade D building paper complying with federal specifications UU-B 790A or asphalt saturated rag felt complying with UL standard number 55-A or other code-recognized equivalent. One layer of Grade D 60 minute paper are required by Uniform Building Code (UBC) for wood based sheathings. Suitable materials for wrapping into rough openings include:

1. FLASHING PRIMER: Water based primer for use prior to application of ACROWRAP<sup>™</sup> and ACROFLASH<sup>™</sup> on all acceptable surfaces.
2. ACROWRAP<sup>™</sup>: 20 mil thick, self-sealing, self-healing rubberized asphalt laminated to a polyethylene film.
3. ACROFLASH<sup>™</sup>: 30 mil thick, self-sealing, self-healing composite membrane of polyester fabric and rubberized asphalt.

The following guidelines provide many of the primary items and considerations for secondary moisture protection barriers.

1. Installation should be in accordance with the secondary moisture protection barrier manufacturer's specifications and applicable building code requirements. Figures 1–5 are examples of typical secondary moisture protection barrier application. Alternative methods may be used to wrap openings. Contact the secondary moisture protection barrier supplier for specific details and installation guidelines.
2. The secondary moisture protection barrier shall be free of any damage such as holes or breaks, and must be applied to all surfaces to receive Acrowall-CP system.
3. Wrap the secondary moisture protection barrier into rough openings prior to installation of doors, windows, etc.
4. Coordinate work with other trades to assure proper sequencing, detailing and installation of materials.

### **TECHNICAL SUPPORT**

Consult BASF Wall Systems' Technical Services Department at 800-589-1336 for specific recommendations concerning all other applications. Consult the Acrocrete<sup>®</sup> website, [www.acrocrete.com](http://www.acrocrete.com), for additional information about products and systems and for updated literature.

**TYPICAL MOISTURE PROTECTION BARRIER APPLICATION**

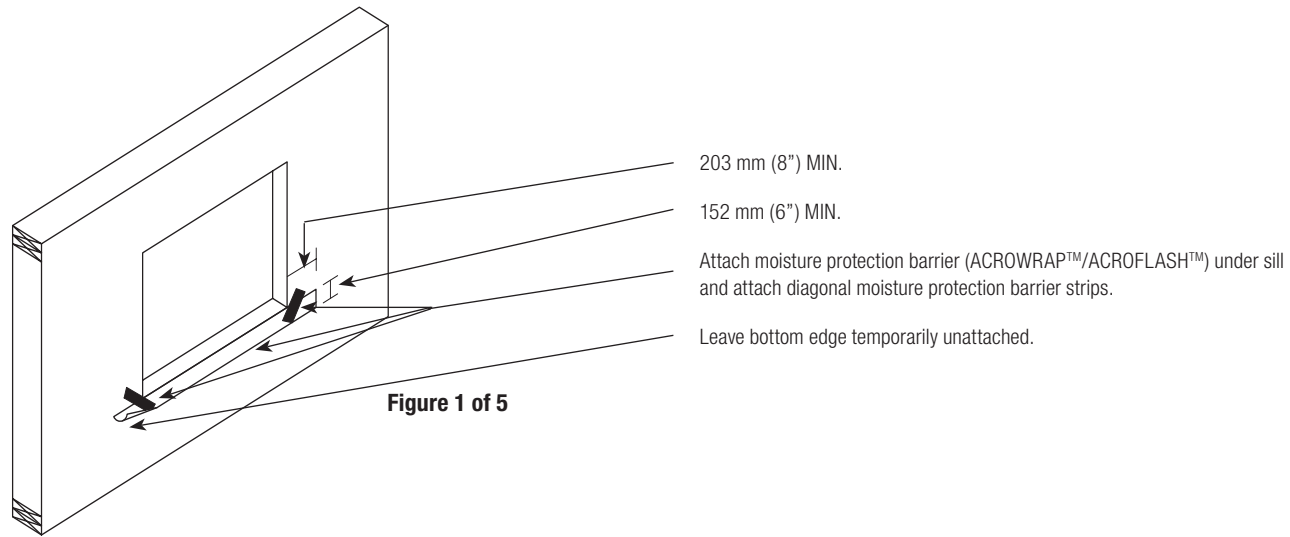

**Figure 1 of 5**

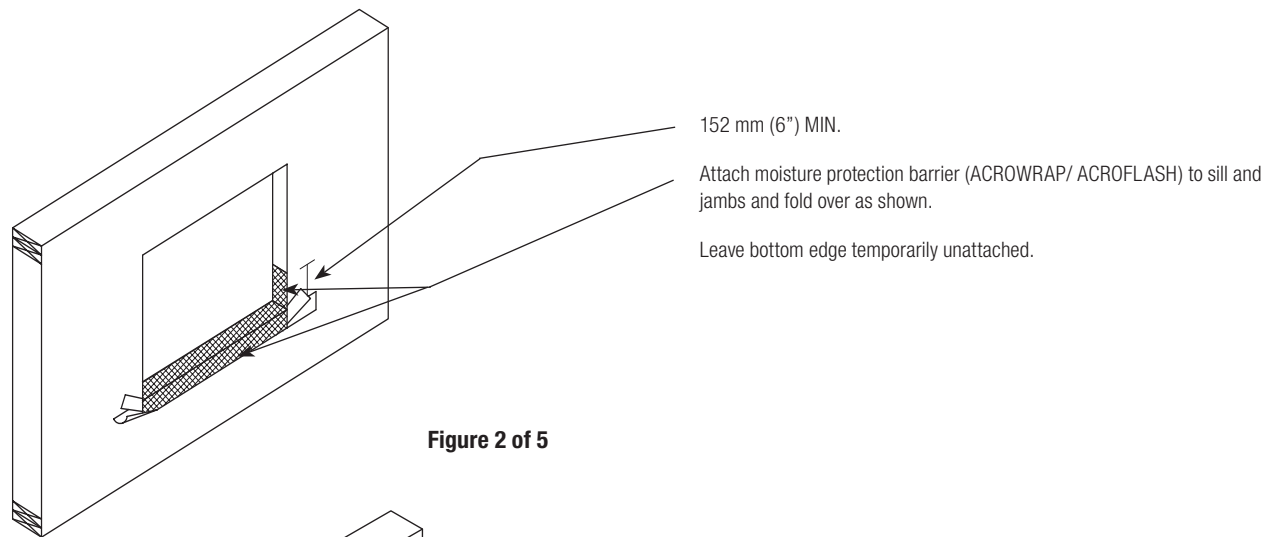

**Figure 2 of 5**

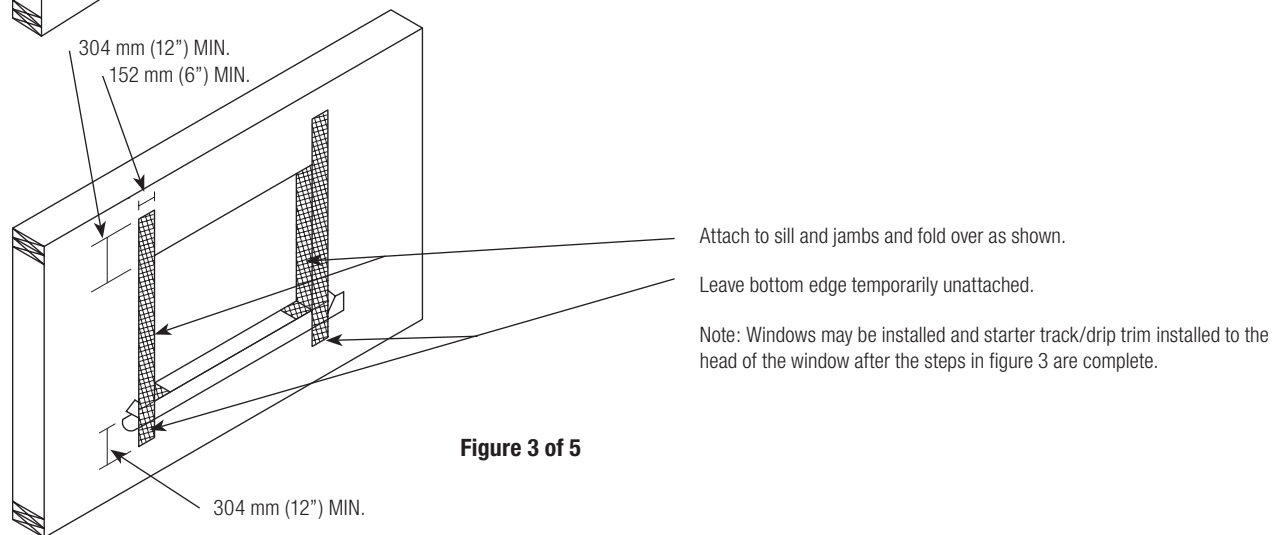

**Figure 3 of 5**

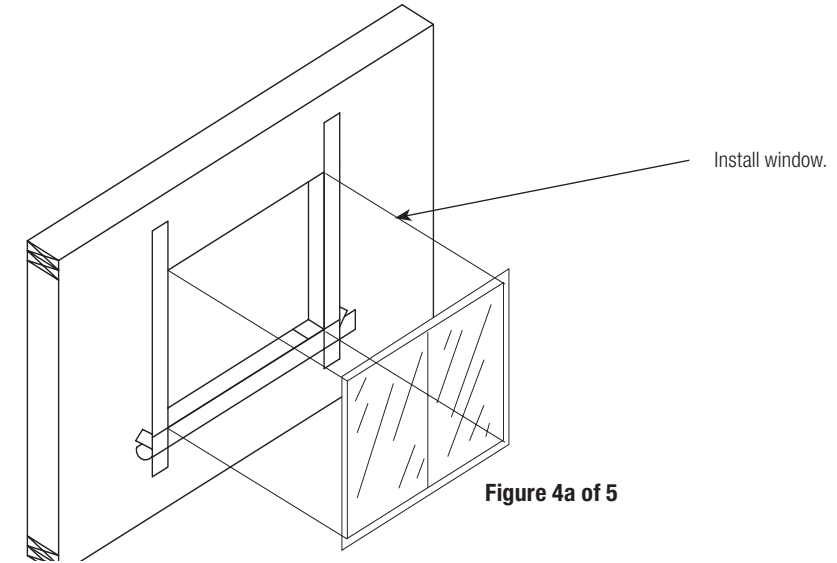

**Figure 4a of 5**

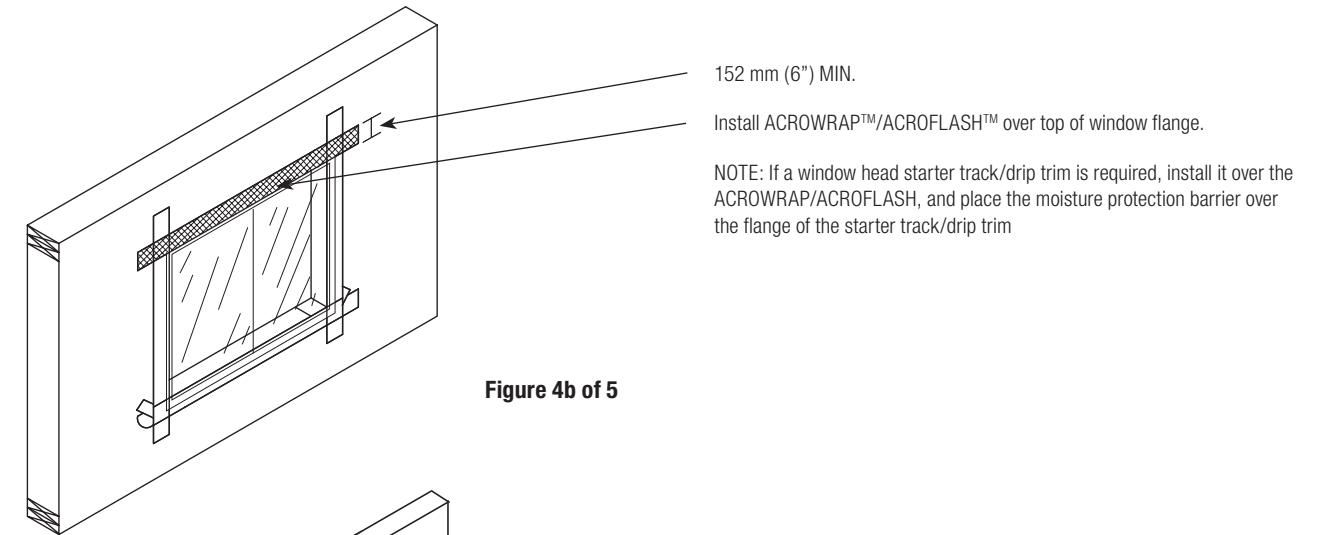

**Figure 4b of 5**

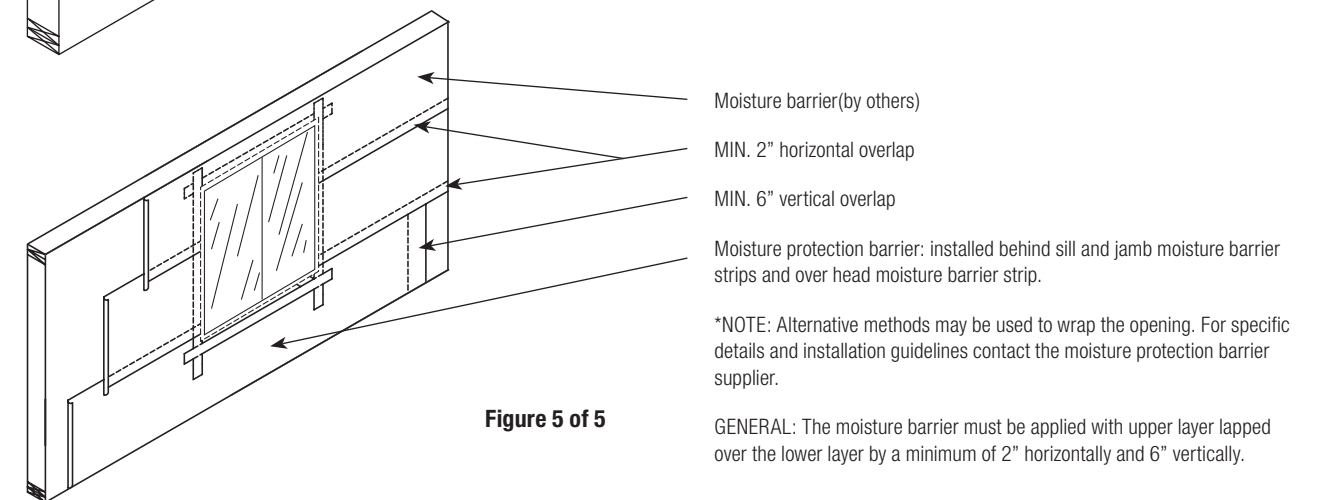

**Figure 5 of 5**



---

## RESIDENTIAL POLICY

On one and two-family residential framed construction, BASF Wall Systems requires that the wall system selected be one that includes provisions for management of incidental moisture. The choices include water-managed EIFS, Acrowall-CP, and Acrowall-CBS. Acrowall Surfacing Systems for insulating concrete forms are also acceptable. There are no exceptions to this policy. Under no circumstances will BASF Wall Systems warrant the use of any other system on this type of construction without expressed written permission from BASF Wall Systems [Residential construction using EIFS on masonry (CMU) or poured concrete does not require the additional water management provisions described above.]

Consult BASF Wall Systems' Technical Services Department for specific recommendations concerning all other applications. Consult the Acrocrete web-site, [www.acrocrete.com](http://www.acrocrete.com) for additional information about products and systems and for updated literature.

## DISCLAIMER

This information and all further technical advice are based on BASF's present knowledge and experience. However, BASF assumes no liability for providing such information and advice including the extent to which such information and advice may relate to existing third party intellectual property rights, especially patent rights. In particular, BASF disclaims all CONDITIONS AND WARRANTIES, WHETHER EXPRESS OR IMPLIED, INCLUDING THE IMPLIED WARRANTIES OF FITNESS FOR A PARTICULAR PURPOSE OR MERCHANTABILITY. BASF SHALL NOT BE RESPONSIBLE FOR CONSEQUENTIAL, INDIRECT OR INCIDENTAL DAMAGES (INCLUDING LOSS OF PROFITS) OF ANY KIND. BASF reserves the right to make any changes according to technological progress or further developments. It is the customer's responsibility and obligation to carefully inspect and test any incoming goods. Performance of the product(s) described herein should be verified by testing and carried out only by qualified experts. It is the sole responsibility of the customer to carry out and arrange for any such testing. Reference to trade names used by other companies is neither a recommendation, nor an endorsement of any product and does not imply that similar products could not be used.